

Upínací čep DIN 69872A, SK 50 s otvorem

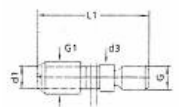
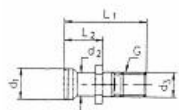
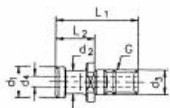
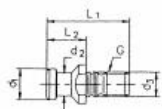
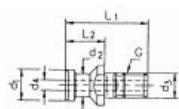

Kód produktu: 13-9884A-50-74
EAN: 4260073577908
Celní tarif: 7318 1590
Hmotnost: 0,25 kg
Dostupnost: skladem

206,61 Kč bez DPH
~~300,00 Kč~~ **250,00 Kč s DPH**
8,26 € bez DPH
~~12,00 €~~ **10,00 € s DPH**

Parametry

D1	28	D2	21	D3	25
D4	11.5	G	M24	L1	74
L2	36	Velikost	SK 50		

Tento produkt najdete v našem [KATALOGU na straně 245 \(2021\)](#)